



BENTZ BOATS

613 BRYDEN AVE. #394
Lewiston ID. 83501
Phone: (208) 746-7035
Fax: (208) 750-0037
bentzboats@bentzboats.com
www.bentzboats.com

Darell Bentz President

Plant Location – 155 Southport



Larry & Joyce Hansen

Larry and Joyce Hansen of Plummer, Idaho wanted a boat that would safely handle the tough whitewater of upper Hell's Canyon and the technical waters of the Salmon River.

Larry and Joyce's boat is powered by Kodiak Marine 383 BFI's and coupled to Hamilton 213's with 3.4 turbo impellers. Standard features include pilot Mariner seat with a passenger Mariner seat and a jump seat on either side, Mariner Seats directly aft with bench seats with backrests, top trays, fish box, heater, pilot and passenger pantograph wipers, full instrumentation, removable rear rails, dome lights and Coast Guard approved running and navigation lights. Extra's include tinted sliding side windows, fish finder, rocket launcher rod holder, watertight cross storage box, stereo with 4 speakers, fish finder, spot lights and aft spreader lights, bow ladder and innovative swim deck ladder configuration

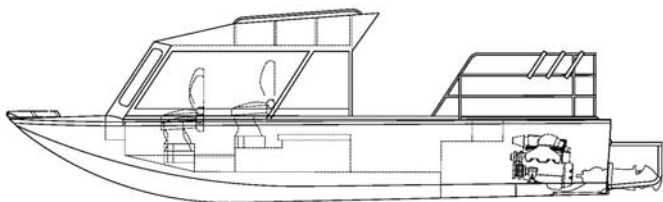
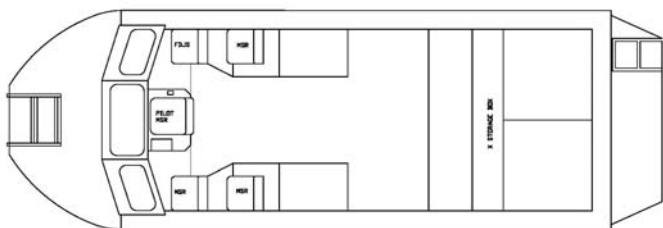

Bentz Boats has set the standard for quality and innovation for over 35 years. Since our 1st aluminum jetboat boat built in 1970 we have developed superior quality, efficient and agile handling boats. Through years of personal and commercial use, customer feedback and innovative designs, Bentz Boats has acquired a domestic and international clientele not only for our superior boat design but also our commitment to quality. Attention to detail and a high quality build standard makes Bentz Boats extremely tough with a high degree of impact resistance and helps ensure that each boat operates with a minimum of maintenance.

Bentz pioneered features include the sled shaped bow, forward and center pilot station, short stroke mechanical stick steering and delta pad bottom. These features contribute to our boats' superior handling, quick planing and shallow running capabilities.

SPECIFICATIONS

Owner: Larry & Joyce Hansen
Private, Recreational

Home Port: Plummer, Idaho

Designer: Darell Bentz

Builder: Bentz Boats, LLC

Construction Material: Aluminum

Length: 26'-0"

Bottom: 7'

Beam: 9'

Draught: 8"

Engines: 2-383 Kodiak Marine

Jet Units: 2-213 Hamilton Jet

Impellers: 3.4Kw Turbo Impellers

Maximum Speed: ~ 55 mph

Cruising Speed: ~ 35 mph

Fuel: 160 Gallon Gas

Range: 350 Miles

*Often Imitated, Never Duplicated
Nobody Knows Aluminum Jet Boats and Rivers Like Bentz Boats*



BENTZ BOATS

613 BRYDEN AVE. #394
Lewiston ID. 83501
Phone: (208) 746-7035
Fax: (208) 750-0037
bentzboats@bentzboats.com
www.bentzboats.com

Darell Bentz President

Plant Location – 155 Southport



*Often Imitated, Never Duplicated
Nobody Knows Aluminum Jet Boats and Rivers Like Bentz Boats*